

# GRIP HEATER & ATTACHMENT

Accessory Name	Parts Number	Application Model	Issue Date	Publication No.	FRT
GRIP HEATER & ATTACHMENT	08T70-MLN-E00	CRF1100A/D	2023.8	MII	0.9 H

### Introduction







ALL INFORMATION, ILLUSTRATIONS, DIRECTIONS AND SPECIFICATIONS INCLUDED IN THIS PUBLICATION ARE BASED ON THE LATEST PRODUCT INFORMATION AVAILABLE AT THE TIME OF APPROVAL FOR PRINTING. Honda Motor Co., Ltd. RESERVES THE RIGHT TO MAKE CHANGES AT ANY TIME WITHOUT NOTICE AND WITHOUT INCURRING ANY OBLIGATION WHATSOEVER. NO PART OF THIS PUBLICATION MAY BE REPRODUCED WITHOUT WRITTEN PERMISSION. THIS MANUAL IS WRITTEN FOR PERSONS WHO HAVE ACQUIRED BASIC KNOWLEDGE OF MAINTENANCE ON Honda MOTORCYCLES, MOTOR SCOOTERS OR ATVS.

Honda Dealer:  
Please give a copy of these instructions to your customer.

Customer:  
Because it requires specialized knowledge and special tools and equipment, it is recommended to install it at a dealer with qualified automobile maintenance.

### How To Read These Symbols

Your safety, and the safety of others, is very important. To help you make informed decisions we have provided safety messages and other information throughout this manual.

-  **WARNING** You CAN be KILLED or SERIOUSLY HURT if you don't follow instructions.
-  **CAUTION** You CAN be HURT if you don't follow instructions.
-  **NOTICE** The purpose of this message is to help prevent damage to your vehicle, other property, or the environment.
-  **NOTE** Things you want to know, things that are useful to know.
-  Follow the instructions of the Service Manual.
-  Follow the other symbol instructions of the "Installation Instructions BASIC".

Instruction Other Symbols  
The symbols used throughout this instructions show specific service procedures. Refer to "Installation Instructions BASIC" for description of each symbol.

## INFORMATION

### WARNING

- Be sure to open and close the throttle to check for smooth operation after installation of the right heated grip.

### CAUTION

- To prevent burns, allow the engine, exhaust system, radiator, etc., to cool before installing the accessory.

### NOTICE

- Take care not to damage the painted surfaces of the motorcycle.
- Do not place magnetic field sensitive objects or magnets around the APS unit.

## TORQUE INFORMATION

Refer to the Service Manual for the torque values including standard torque of the removed parts. ()



# INSTALLATION

1. Refer to the Service Manual for motorcycle, remove the motorcycle parts as shown, and disconnect the negative (-) cable from the battery. (📖)

<LEFT SIDE>

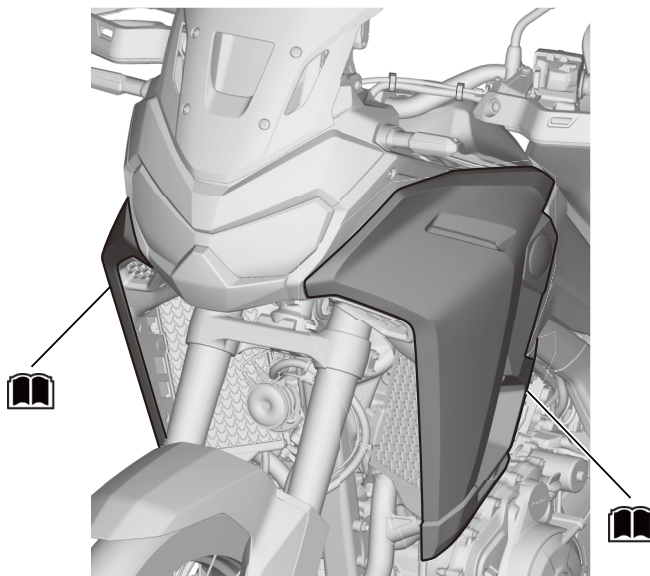
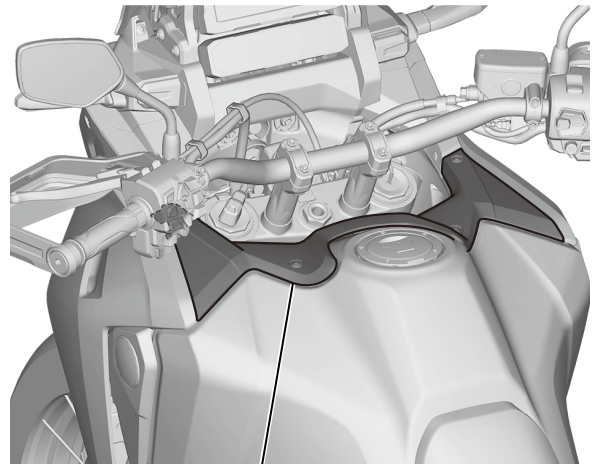
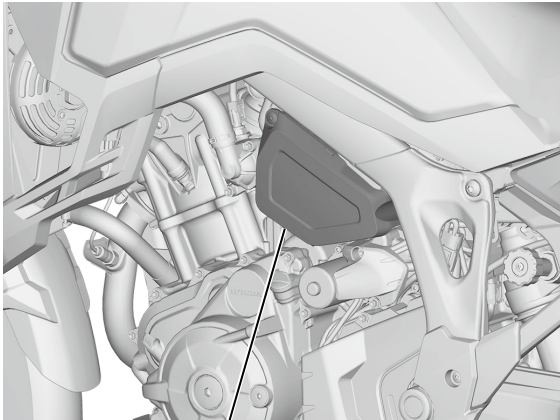

INSTALLATION IMAGE

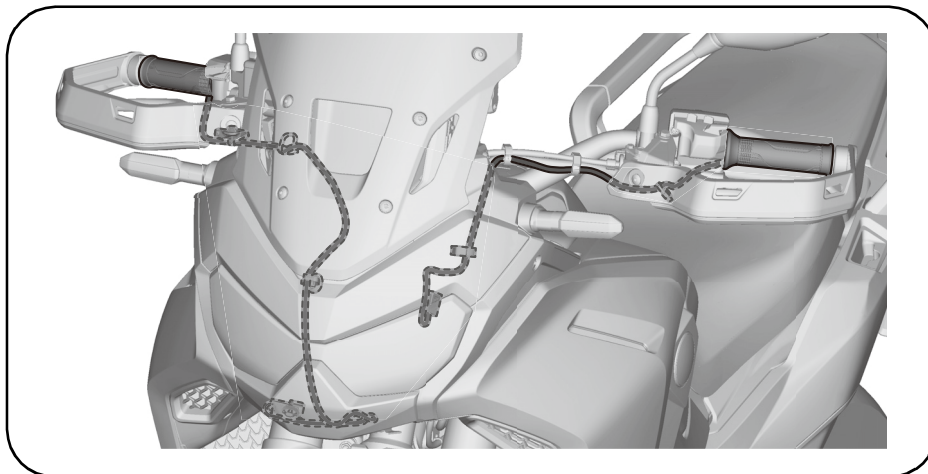

2. Refer to the Service Manual for motorcycle, remove the motorcycle parts as shown. (📖)

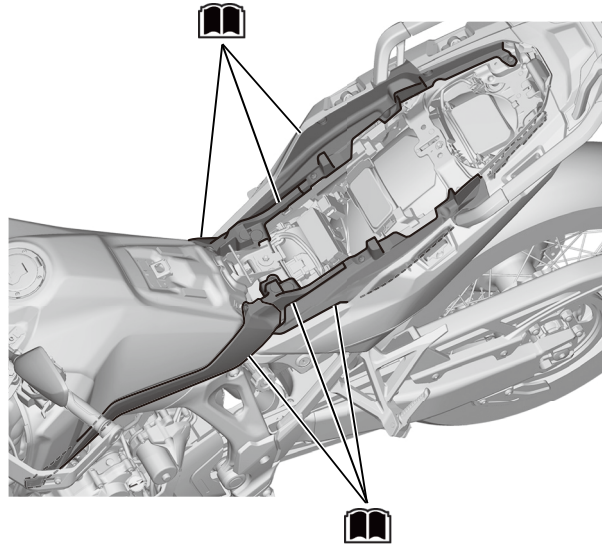
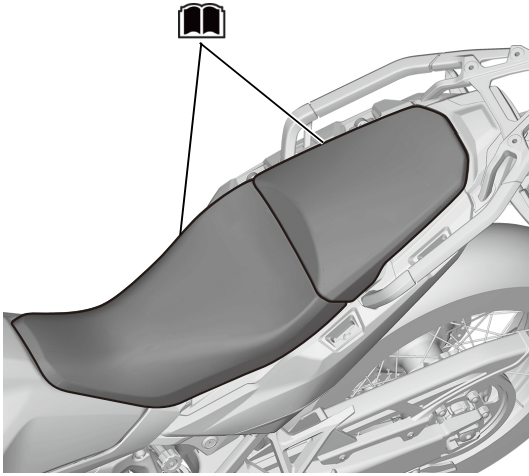

3. Refer to the Service Manual for motorcycle, lift the fuel tank as shown. (📖)

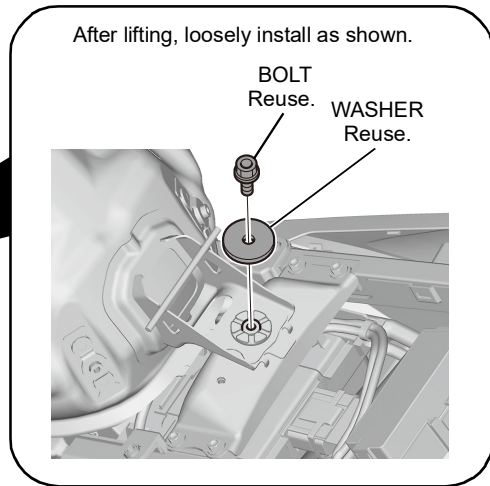
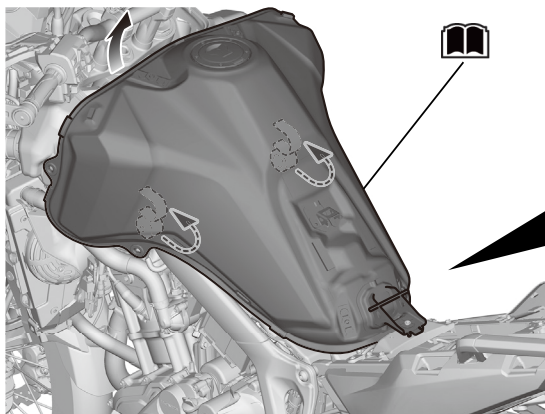

4. Refer to the Service Manual for motorcycle, remove the motorcycle parts as shown. (📖)

<LEFT SIDE>

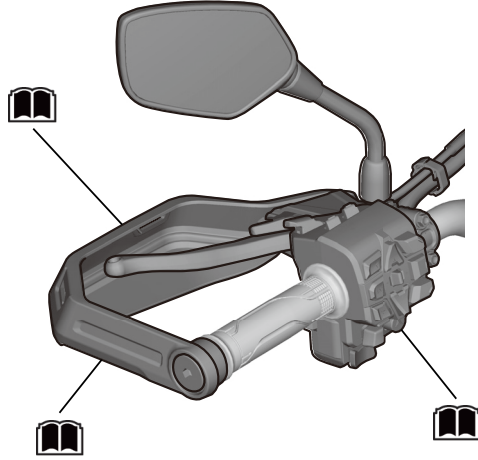

5. Remove the motorcycle's parts as shown.

<LEFT SIDE>

LEFT GRIP

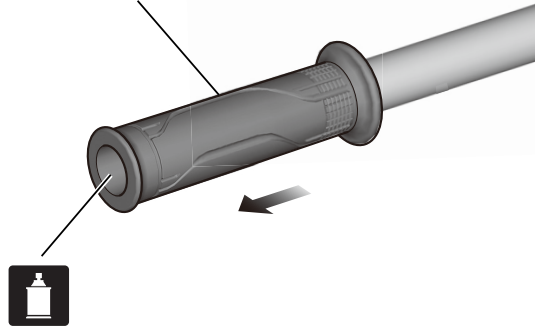

6. Install as shown.

<LEFT SIDE>

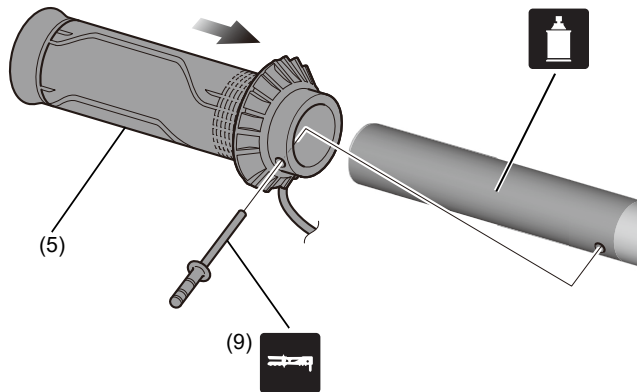

7. Refer to the Service Manual for motorcycle, install the parts removed in step 4 in the reverse order of removal. (🔧)

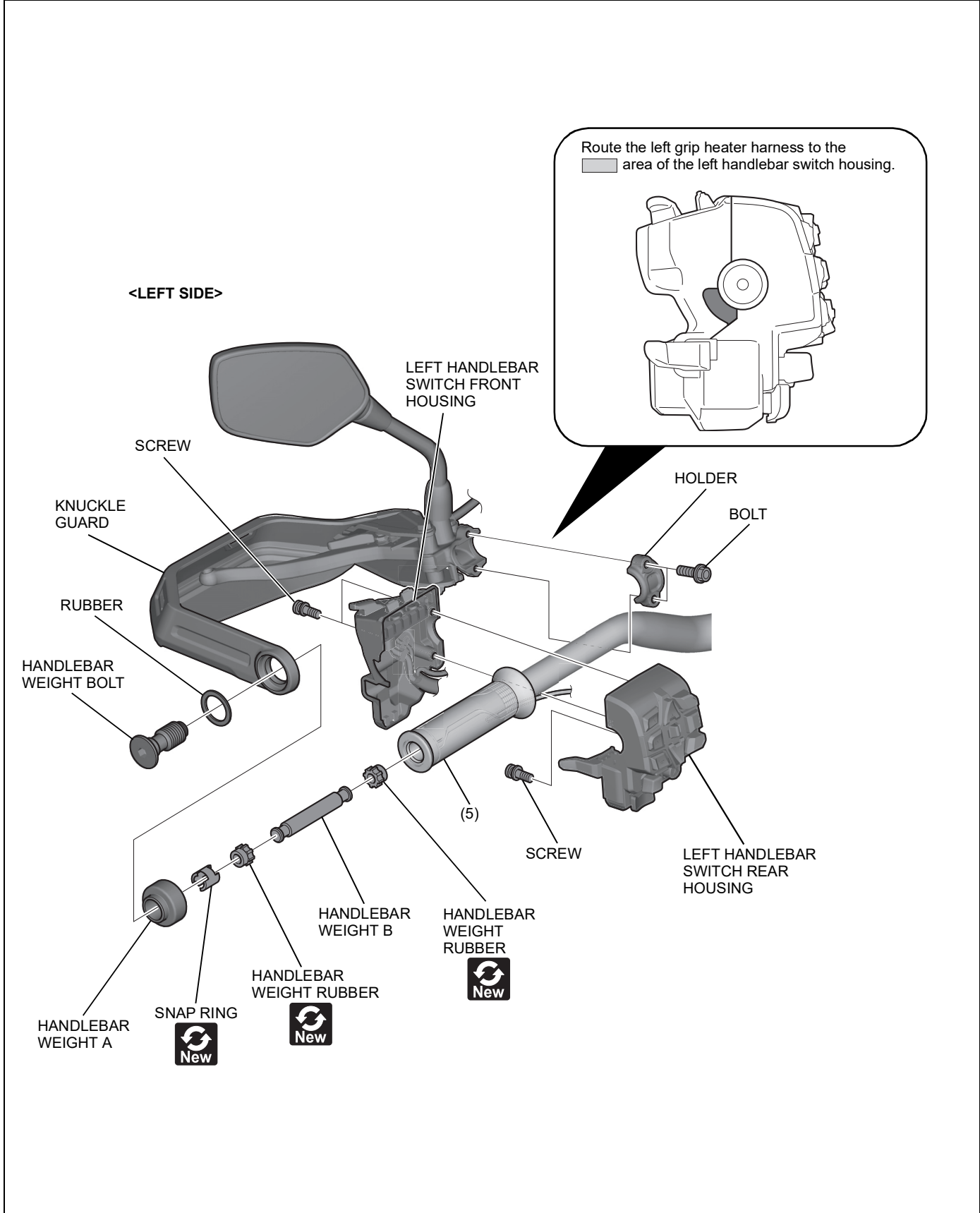

8. Install as shown.  
 • Confirm that any harness is not caught or too tight.

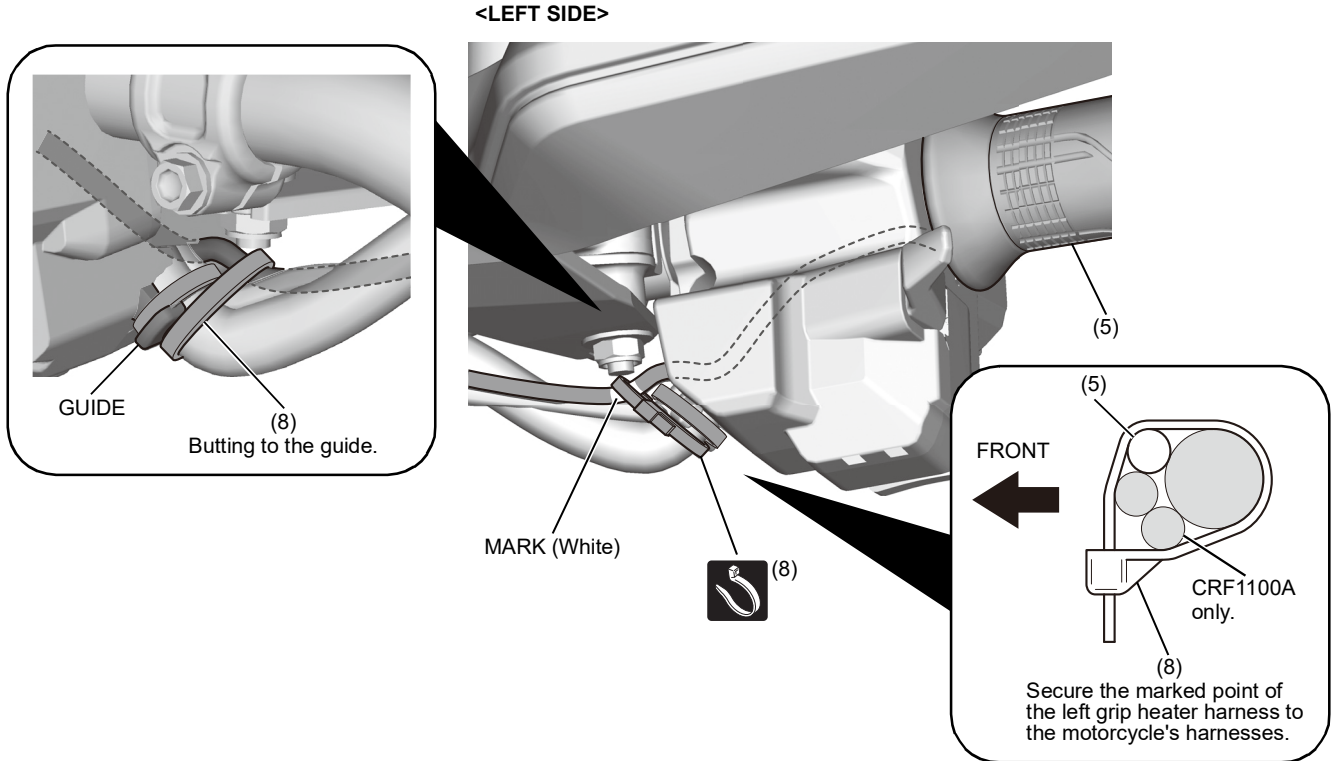

9. Install as shown.

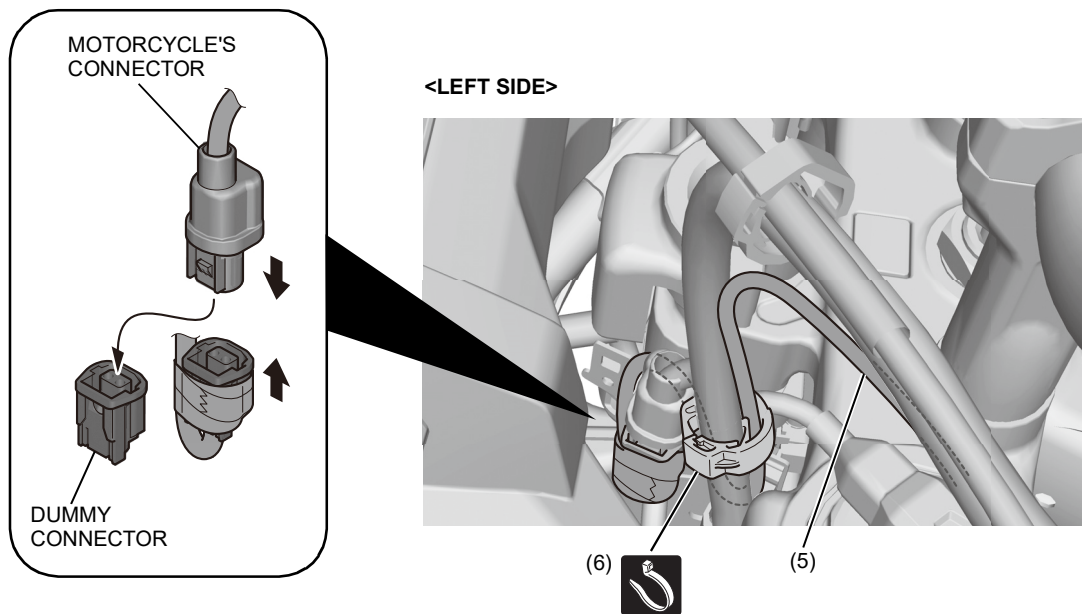

10. Secure as shown.

<LEFT SIDE>

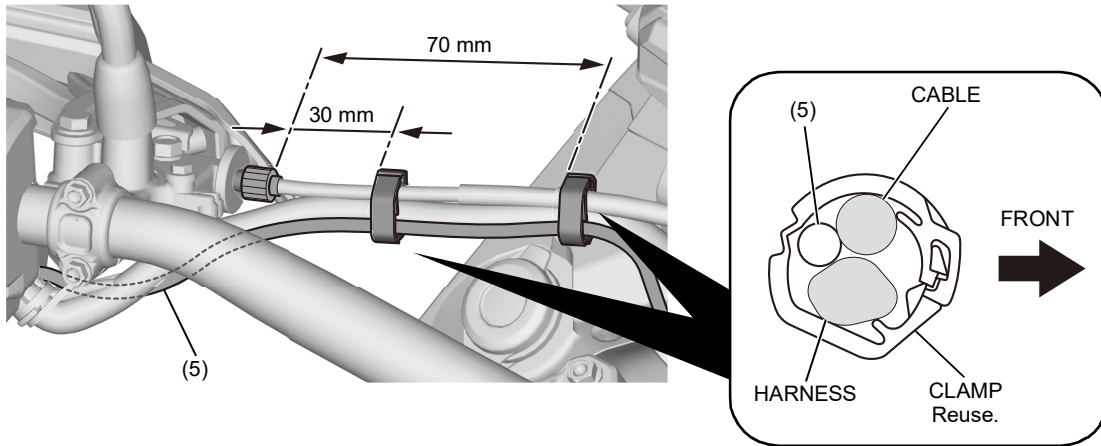

11. Refer to the Service Manual for motorcycle, remove the motorcycle parts as shown. (📖)

<RIGHT SIDE>

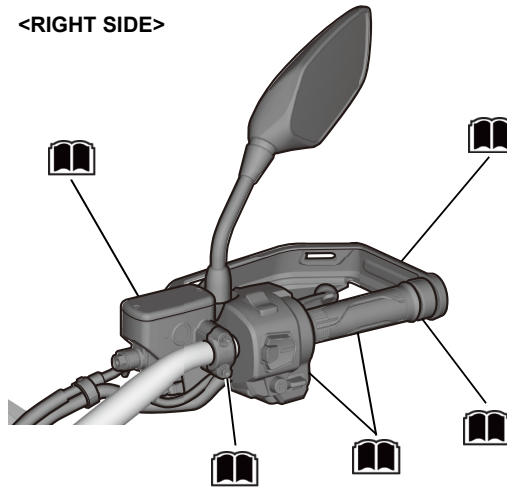

12. Mark in the position shown.

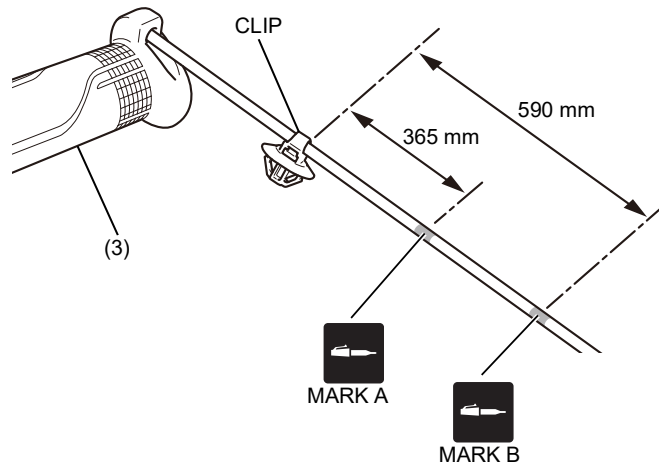





16. Install as shown.

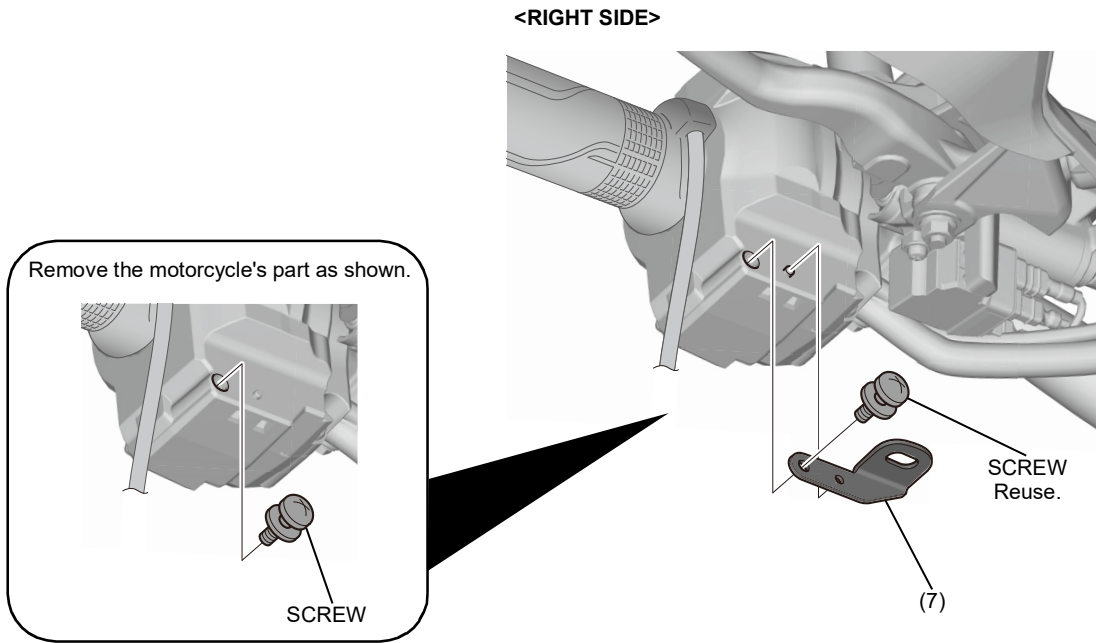

17. Install as shown.

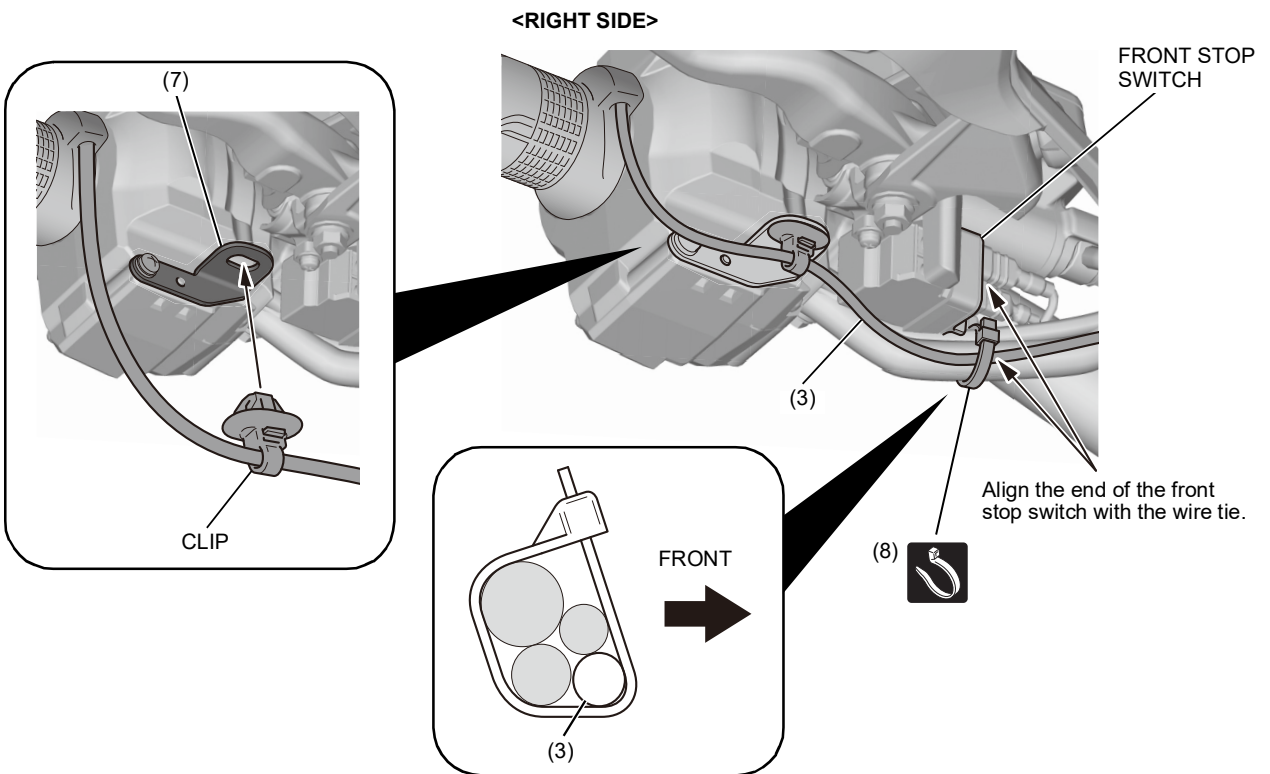

18. Route the harness as shown.

<RIGHT SIDE>

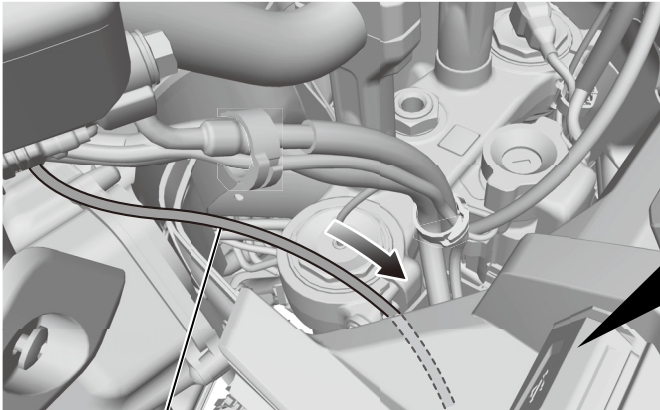

(3)

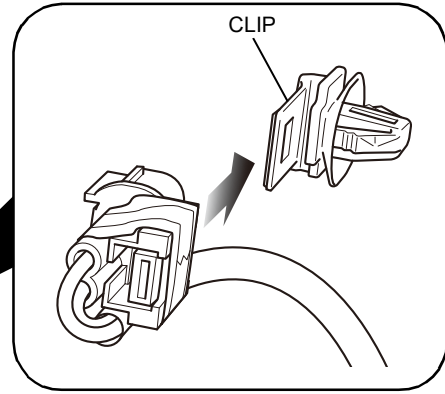

19. Remove the clip as shown.

<RIGHT SIDE>

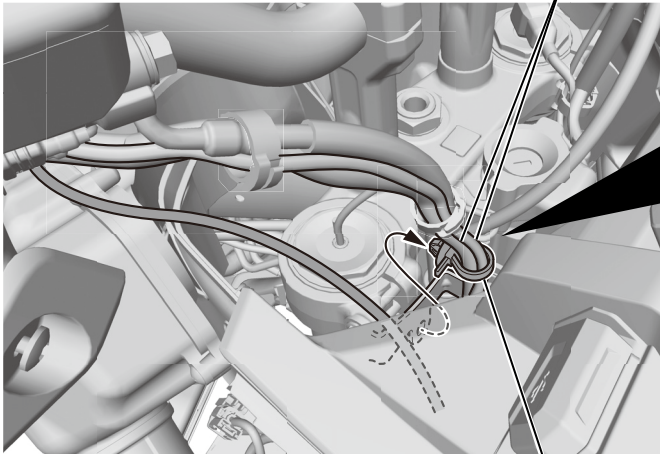

CLIP BAND

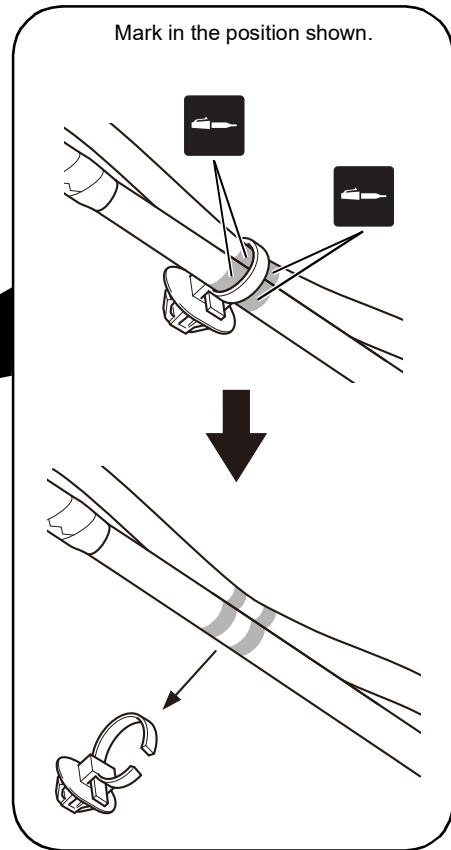

20. Install as shown.

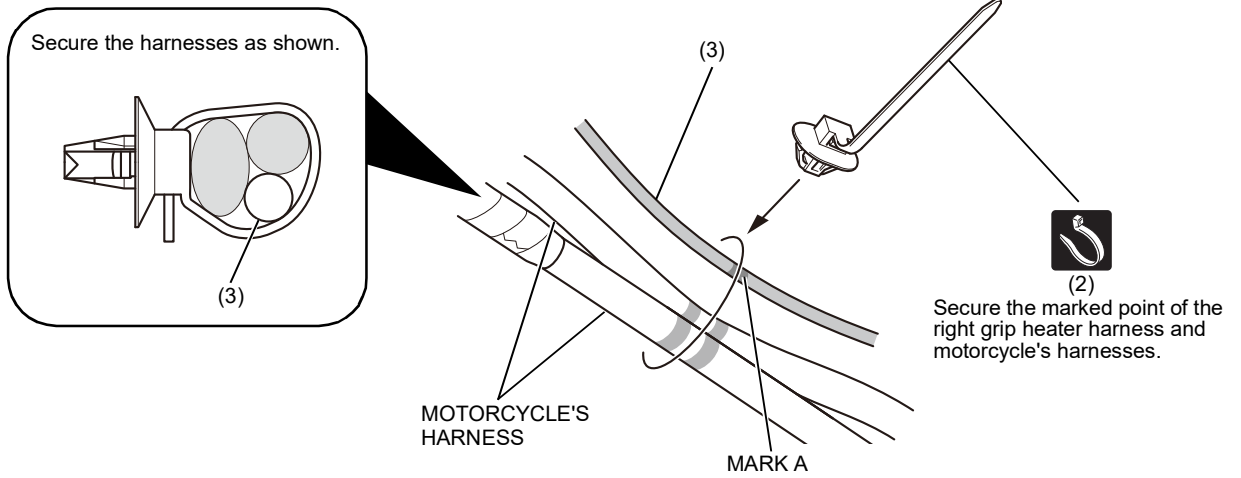

21. Remove as shown.

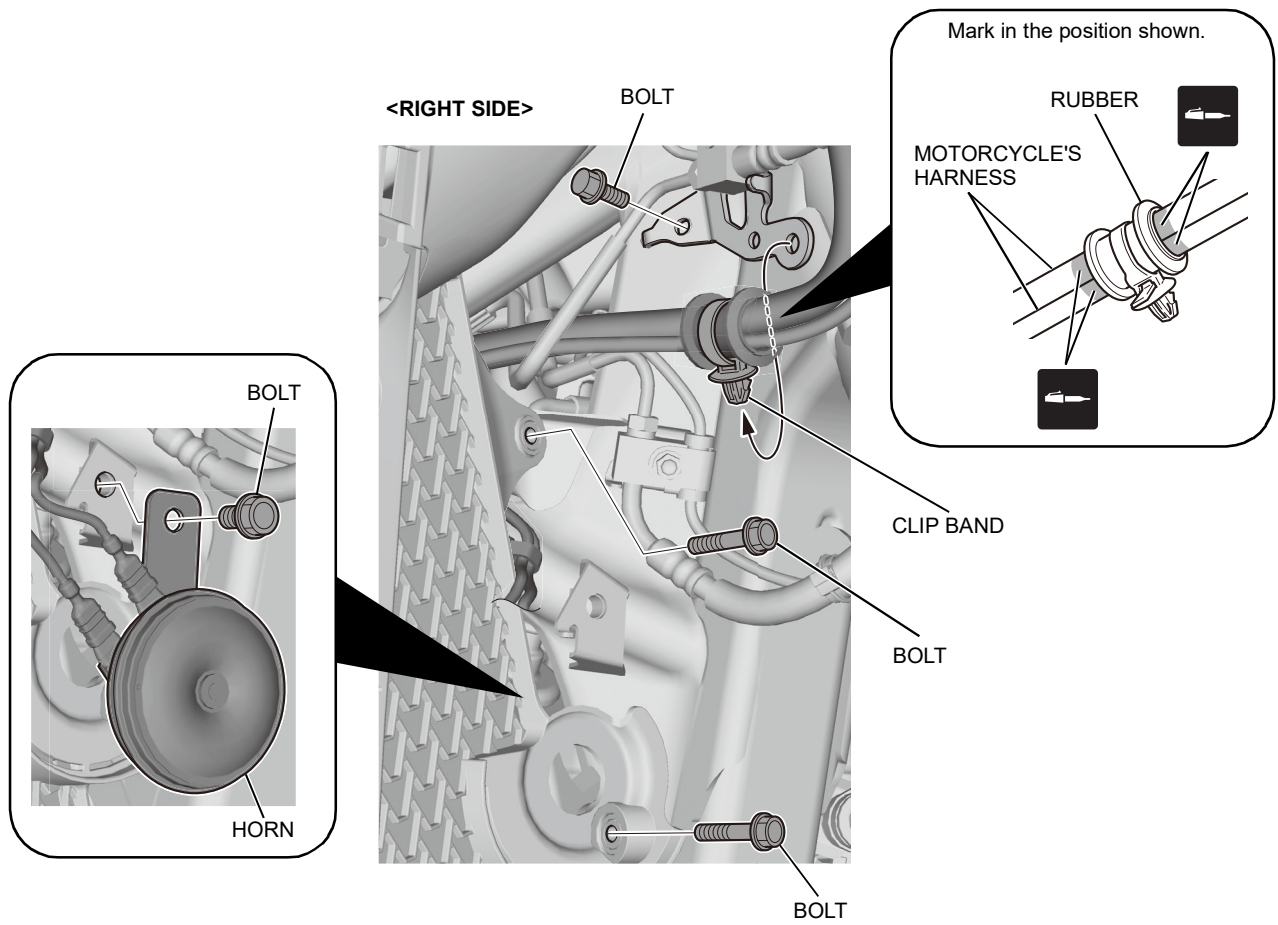

22. Remove as shown.

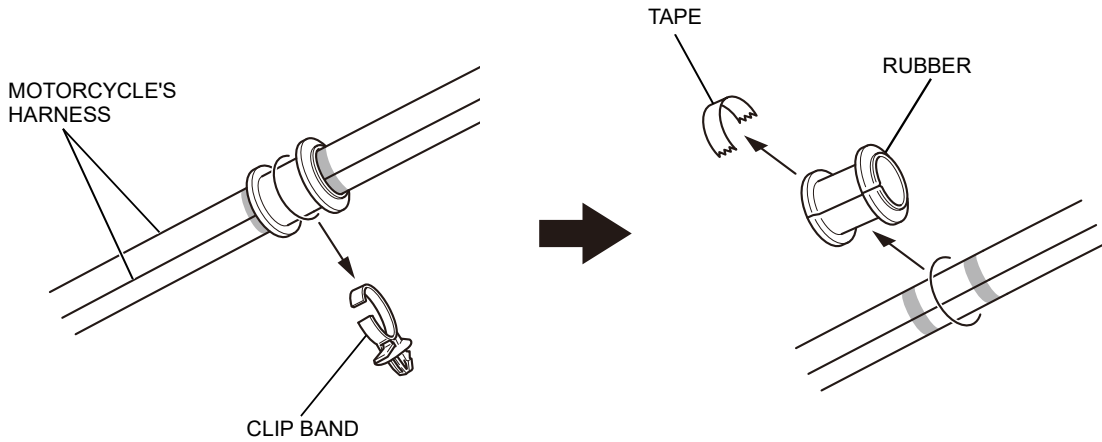

23. Wind the electrical tape as shown.

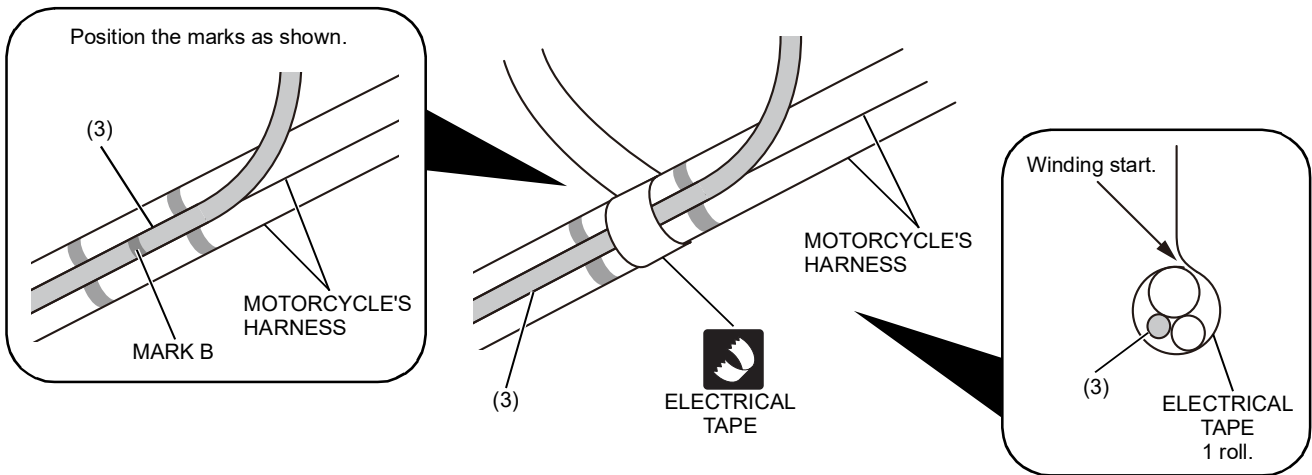

24. Install as shown.

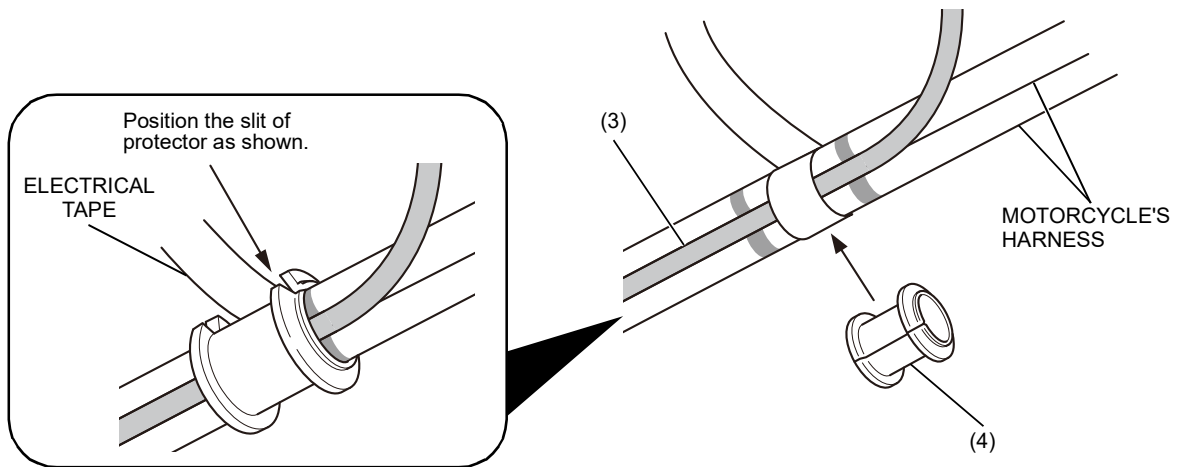

25. Secure as shown.

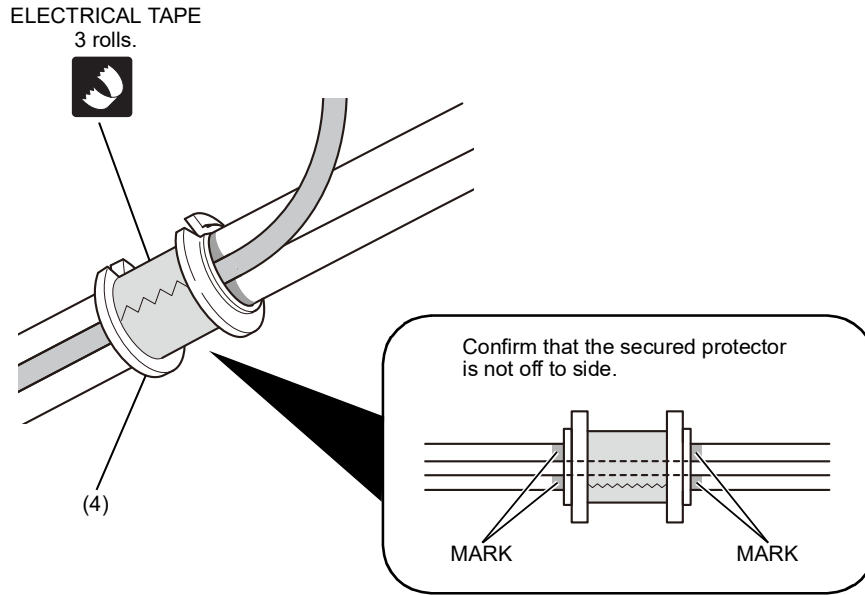

26. Install as shown.

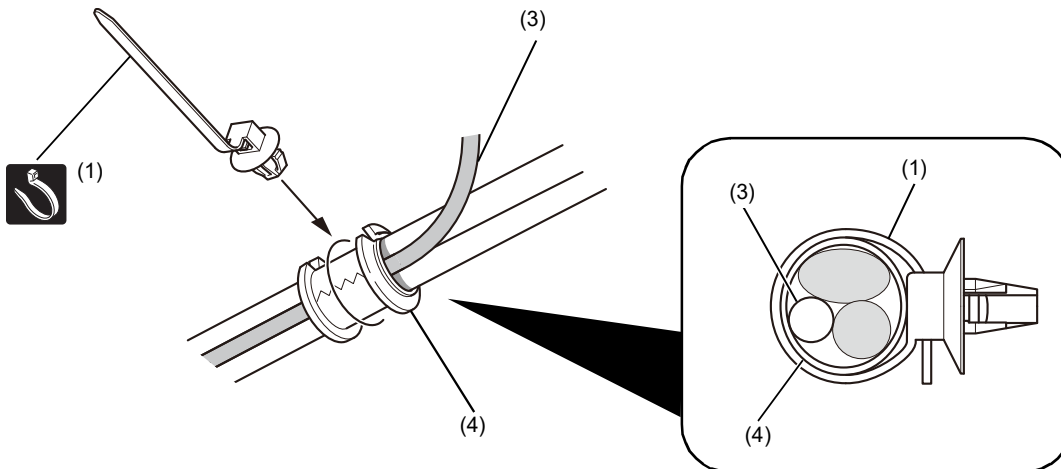

27. Remove the motorcycle's parts as shown.

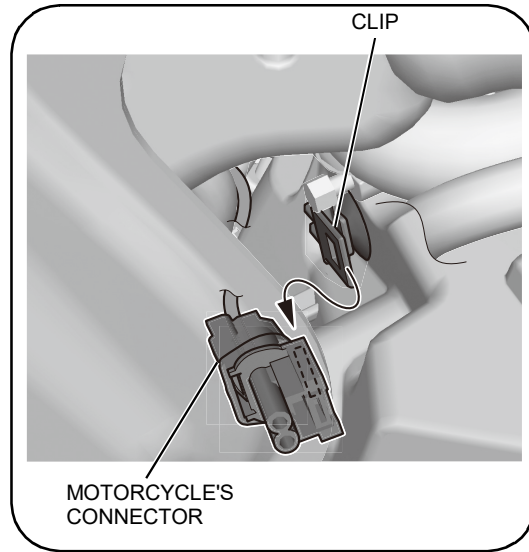

<RIGHT SIDE>

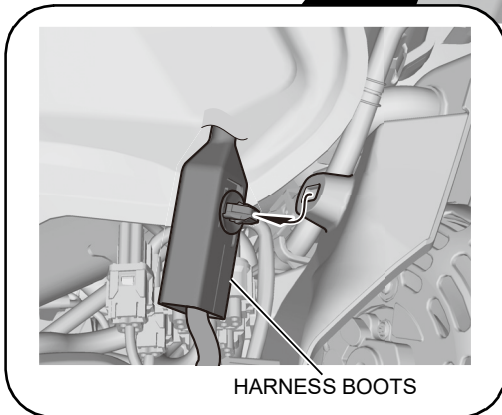
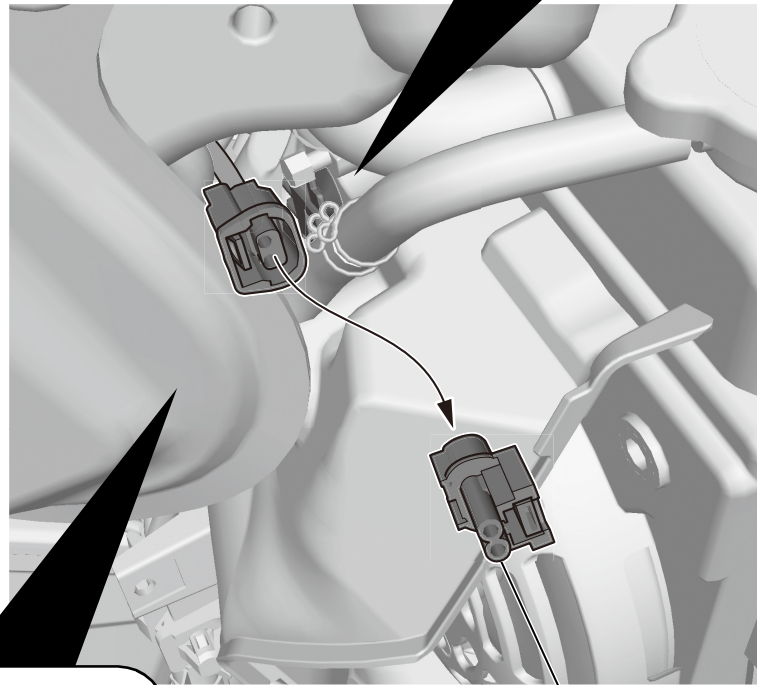

28. Route the right grip heater harness as shown.

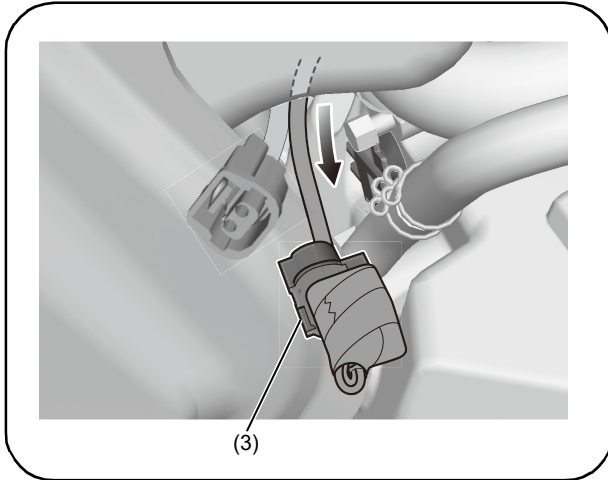

<RIGHT SIDE>

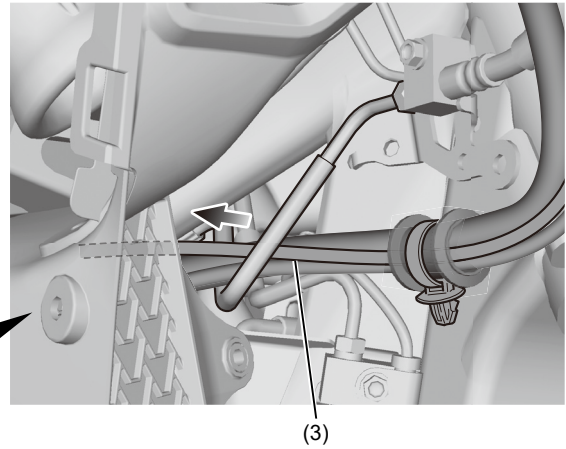

29. Install as shown.

<RIGHT SIDE>

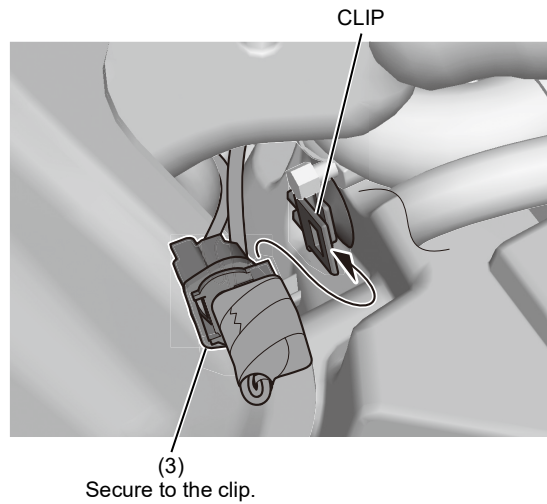
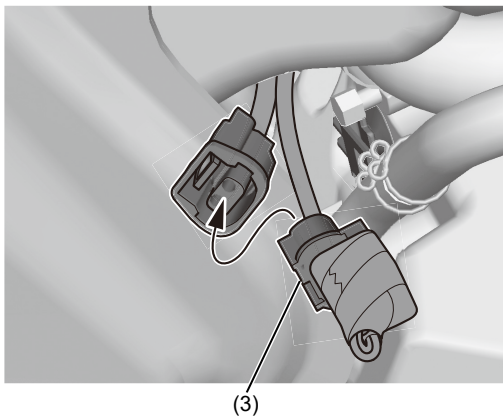



30. Install as shown.

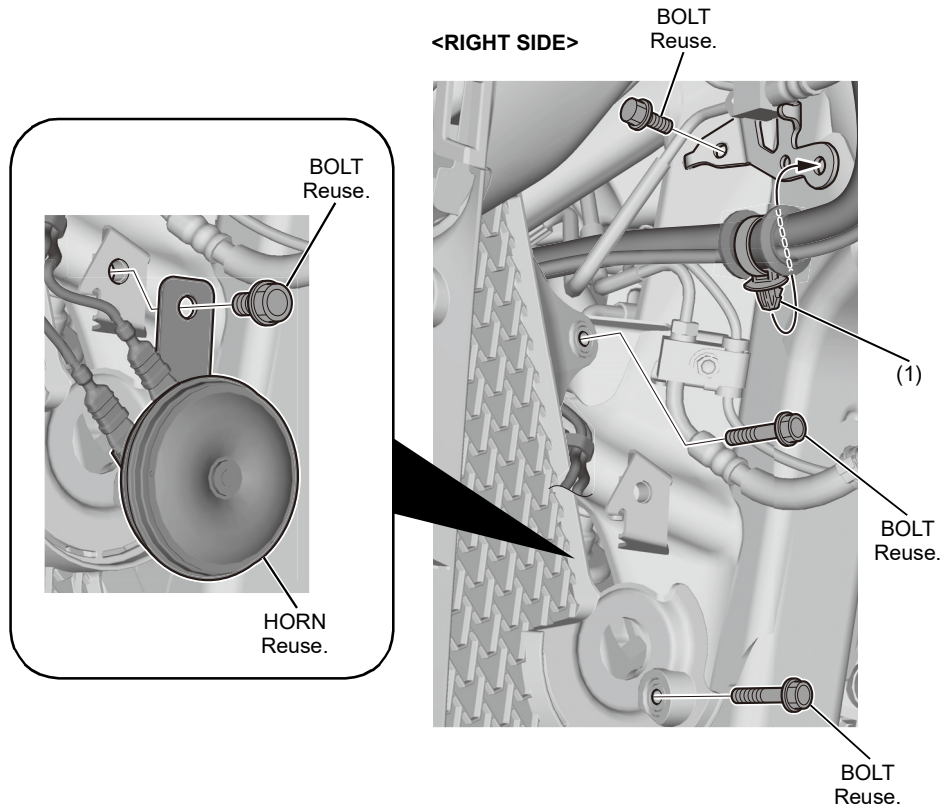

31. Secure as shown.

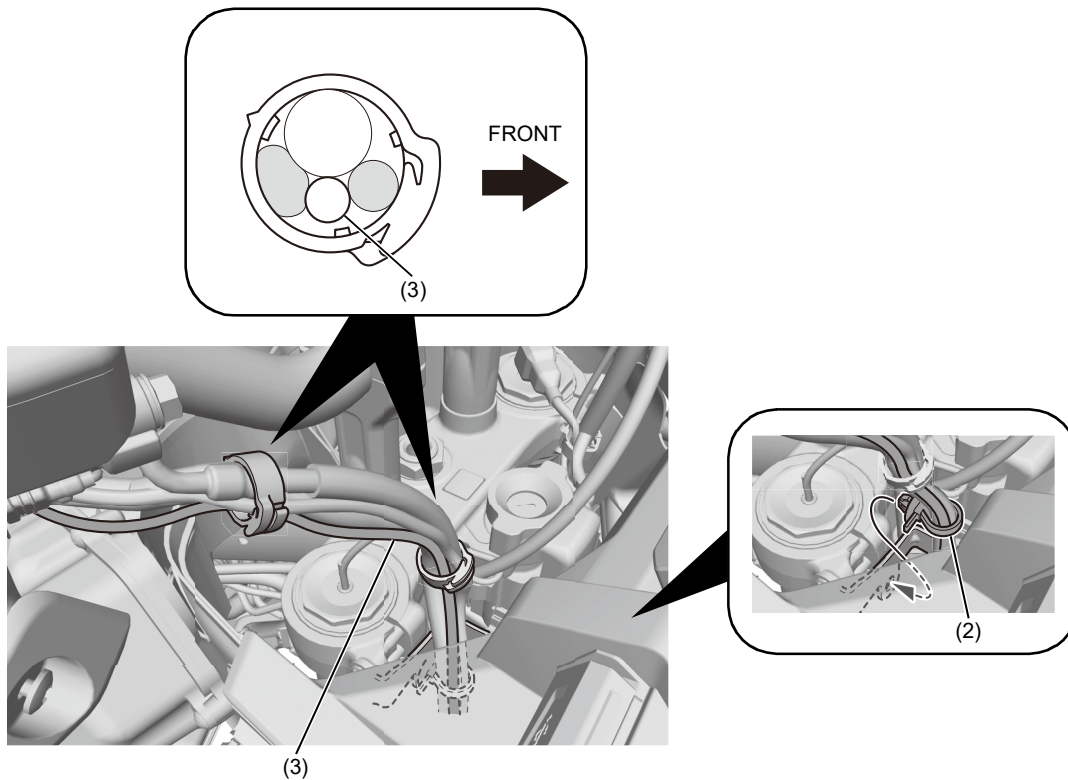

32. Install the motorcycle's parts in the reverse order of removal.  
• Confirm that any harness is not caught or too tight.

## SETTING INSTRUCTIONS

1. Open the rear seat and connect the SCS short connector (070MZ-0010300).
2. Turn the ignition switch ON with the engine stop switch RUN, but does not start the engine.
3. Pull backward and hold the PAGE switch or touch the clock area of the multi-information display.

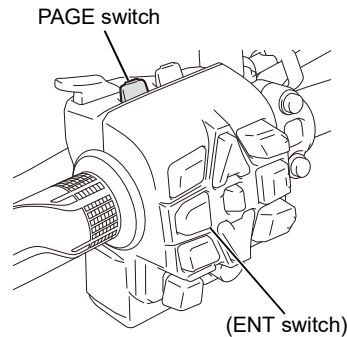

4. Select the "Settings", and then press the ENT switch.

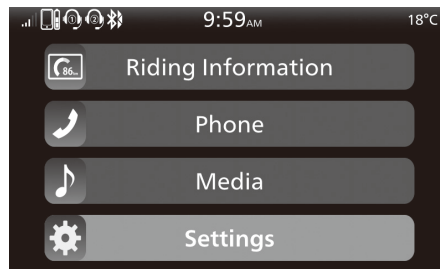

5. Select the "Service", and then press the ENT switch.

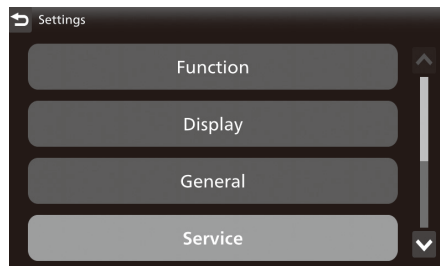

6. Select the "Equipment", and then press the ENT switch.

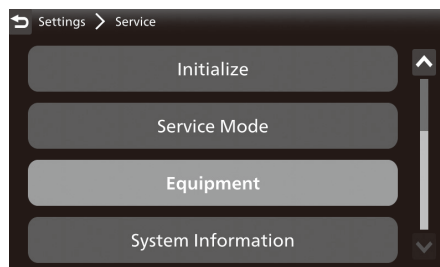

7. Select the "Grip Heater", and then press the ENT switch to "ON" the function.

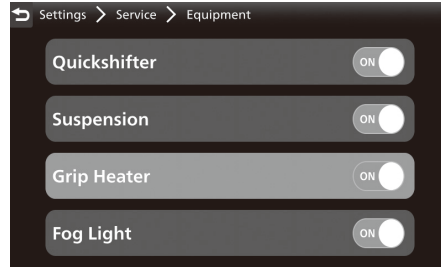

8. Turn the ignition switch OFF and remove the SCS short connector.

## DEALER TROUBLESHOOTING

- Stop the engine and turn the ignition switch OFF when you check the parts and circuits other than those of the grip heaters.

Symptom	Check
<p>Grip heater status icon and grip heater level blinks.</p> <p>The image shows the instrument cluster with two callouts: 'GRIP HEATER STATUS ICON' pointing to a small icon on the display, and 'GRIP HEATER LEVEL' pointing to a row of five indicator lights below the display.</p>	<p>If there is a malfunction, check the following.</p> <ol style="list-style-type: none"> <li>1. Body control system DTC: <ul style="list-style-type: none"> <li>• Refer to the service manual for the motorcycle.</li> </ul> </li> <li>2. Grip heater resistance: <ul style="list-style-type: none"> <li>Check for resistance between the terminals.</li> <li>➡ Standard: <ul style="list-style-type: none"> <li>Right: 1.9 ohms +/- 10%</li> <li>Left: 1.9 ohms +/- 10%</li> </ul> </li> <li>If the resistance is out of specification, replace the grip heater.</li> </ul> </li> </ol> <p>The grip heaters and their circuits are OK, check the following.</p> <ol style="list-style-type: none"> <li>1. METER <ul style="list-style-type: none"> <li>• Refer to the service manual for the motorcycle.</li> </ul> </li> </ol>